



## FARNSWORTH DRIVE

EDGWARE, HA8 8FS

**£315,000**  
**LEASEHOLD**

Taylor Hawkins presents this beautiful modern one-bedroom apartment located on the first floor. Situated in a popular development, the property offers a spacious contemporary open-plan kitchen, a bright living area leading onto a private balcony, and a stylish bathroom with a bathtub. The apartment benefits from a long lease and is conveniently close to local transport links, making commuting easy. Residents will also enjoy being within walking distance of a range of shops, cafes, and amenities, adding to the appeal of this fantastic home.



**TAYLOR HAWKINS**  
Estate Agents  
0208 958 2222 / TaylorHawkins.co.uk



## Farnsworth Drive, Edware, HA8

Approximate Area = 512 sq ft / 47.5 sq m

For identification only - Not to scale

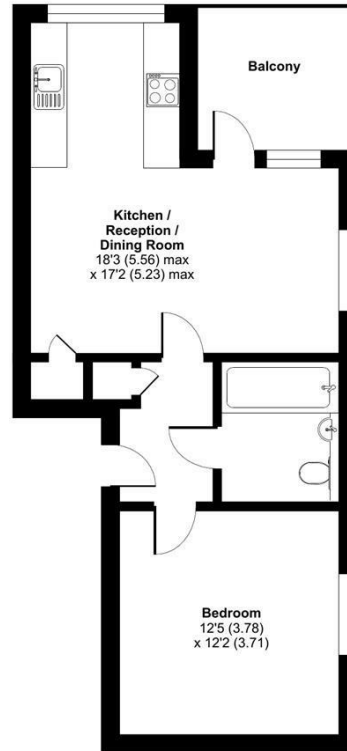

FIRST FLOOR

Floor plan produced in accordance with RICS Property Measurement 2nd Edition,  
Incorporating International Property Measurement Standards (IPMS2 Residential). © nrdhcom 2025.  
Produced for Taylor Hawkins. REF: 1316250



Energy Efficiency Rating		
	Current	Potential
Very energy efficient - lower running costs		
(92 plus) <b>A</b>		
(81-91) <b>B</b>		
(69-80) <b>C</b>		
(55-68) <b>D</b>		
(39-54) <b>E</b>		
(21-38) <b>F</b>		
(1-20) <b>G</b>		
Not energy efficient - higher running costs		
<b>England &amp; Wales</b>	EU Directive 2002/91/EC	

Agents Note: Whilst every care has been taken to prepare these particulars, they are for guidance purposes only. All measurements are approximate and are for general guidance purposes only and whilst every care has been taken to ensure their accuracy, they should not be relied upon and potential buyers/tenants are advised to recheck the measurements

Edware Sales  
58 Edware Way  
Edware  
Middlesex  
HA8 8DJ

020 8958 2222  
property@taylorhawkins.co.uk  
<https://taylorhawkins.co.uk/>



**TAYLOR HAWKINS**  
Estate Agents  
0208 958 2222 / TaylorHawkins.co.uk